

Embedding/Linking videos from the UHI Streaming Server



If you are using videos for teaching, they should all be uploaded to the [UHI streaming server Medial](#). Once your videos are in Medial, you can then either embed the videos in Brightspace or provide students with a link to watch them. This guide will walk you through the steps necessary for embedding or linking a video from the UHI streaming server into your Brightspace modules.

Option 1 – Embedding a video from the UHI streaming server

Go to your module and the content folder where you would like to add a video. Select the 'Upload/Create' drop-down menu (1) and select 'Create a File' (2). (Figure 1)

The screenshot shows the Brightspace interface for a 'Migration' activity. At the top, there are navigation tabs: 'Content', 'Communication and Collaboration', 'Course Tools', 'Library Resources', and 'Help'. Below these is a search bar for 'Search Topics'. The main content area is titled 'Migration' and includes options for 'Add dates and restrictions...', 'Add a description...', 'Published', 'Print', and 'Settings'. A blue 'Upload / Create' button is circled with a purple circle containing the number '1'. A purple arrow points from this button to the 'Create a File' option in the drop-down menu, which is also circled with a purple circle containing the number '2'. Other options in the menu include 'Upload Files', 'Video or Audio', 'Create a Link', 'Add from Manage Files', 'Add Object from LOR', 'New SCORM/xAPI Object', 'New Checklist', and 'New Discussion'. A dashed box indicates a drop zone for files.

Figure 1: Brightspace content area with Upload/Create button and drop-down menu

This will open the HTML editor for you. Give your file a name (1), and select the 'Insert Stuff' button (2). (Figure 2)

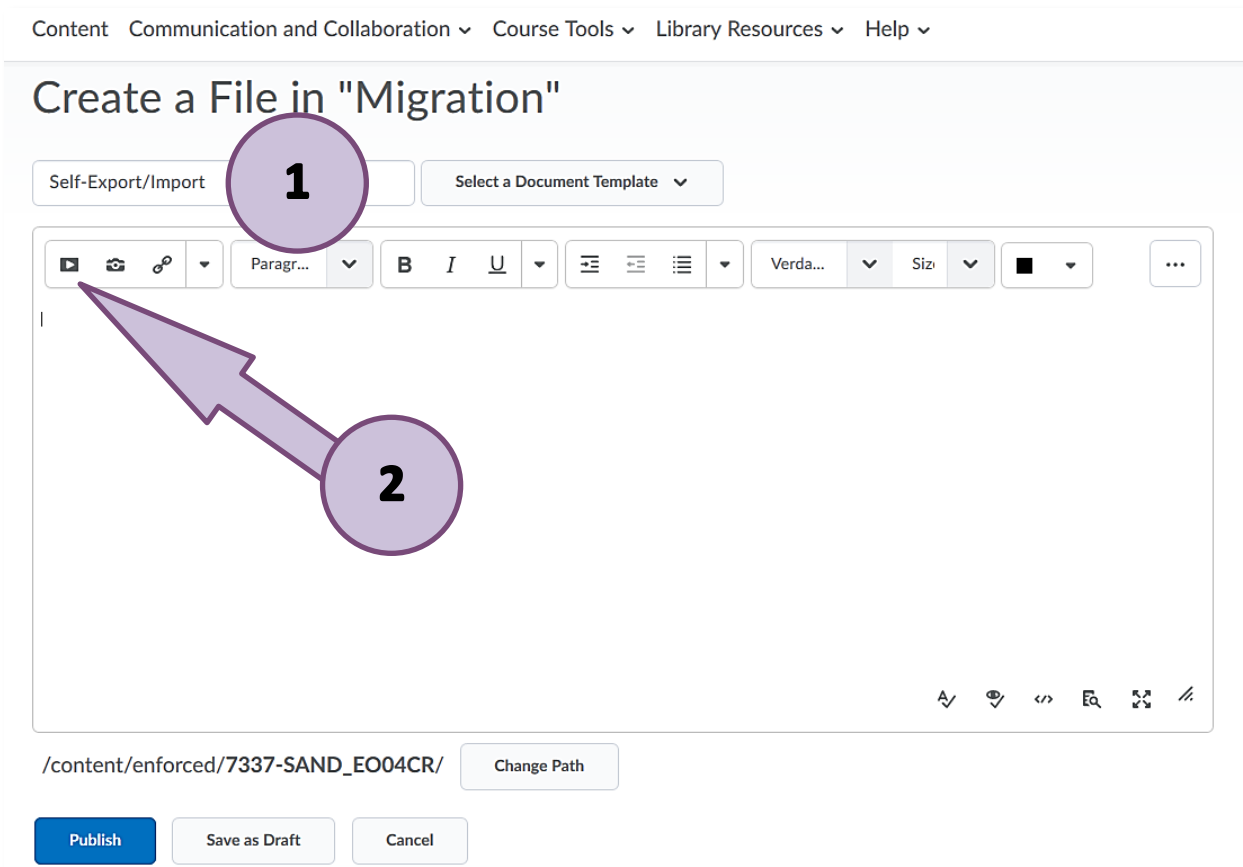

Figure 2: Brightspace HTML editor with Insert Stuff button in the menu

Scroll down and select 'Enter Embed Code'. (Figure 3)

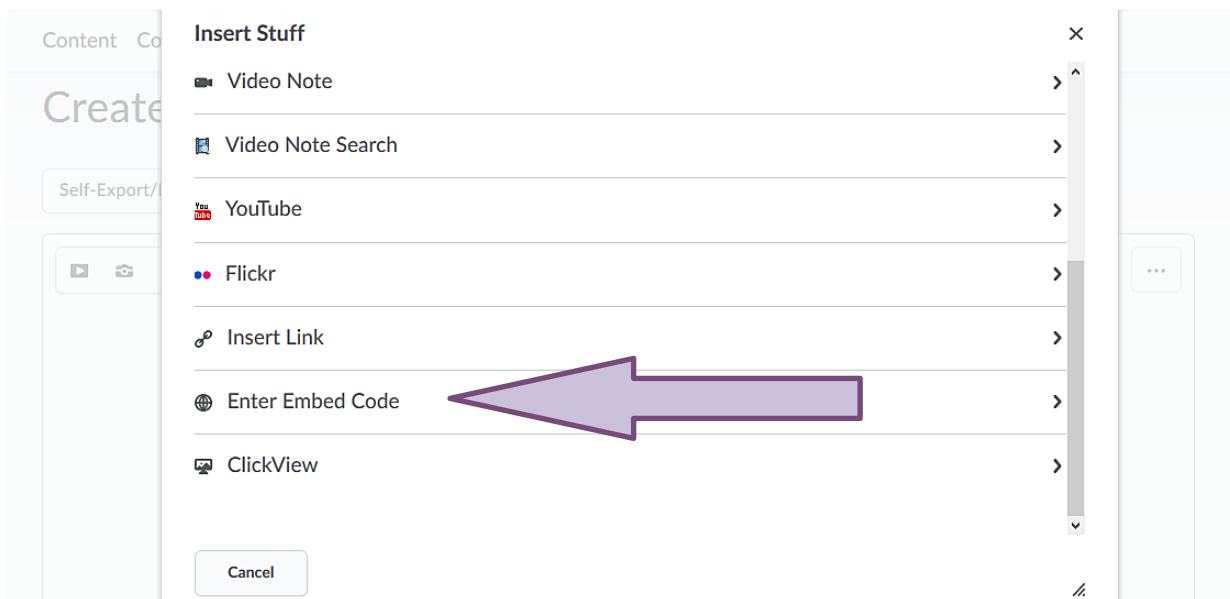

Figure 3: Insert Stuff menu with Enter Embed Code option

Once you have clicked on 'Enter Embed Code', a window will open, where you will be able to enter the embed code. (Figure 4)

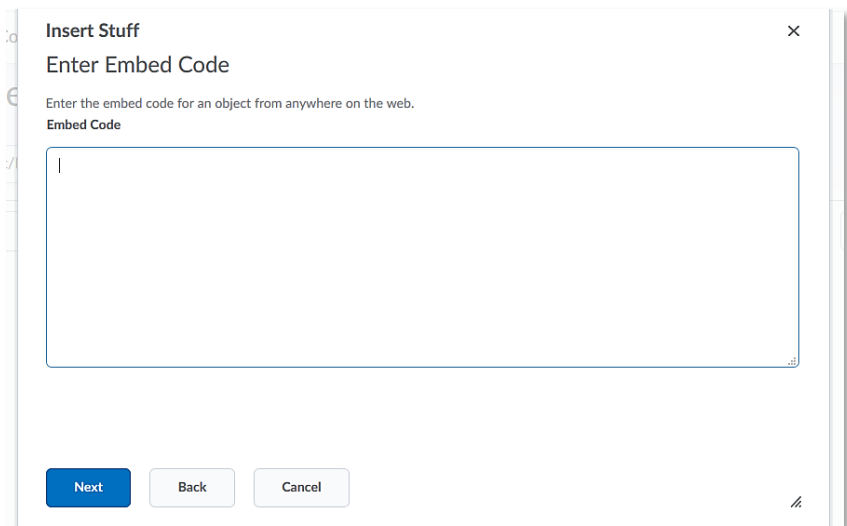

Figure 4: Enter Embed Code window

Go to the UHI streaming server and select the video you would like to embed. Once the video has opened, select the share symbol (↶) at the top right-hand side corner. (Figure 5)

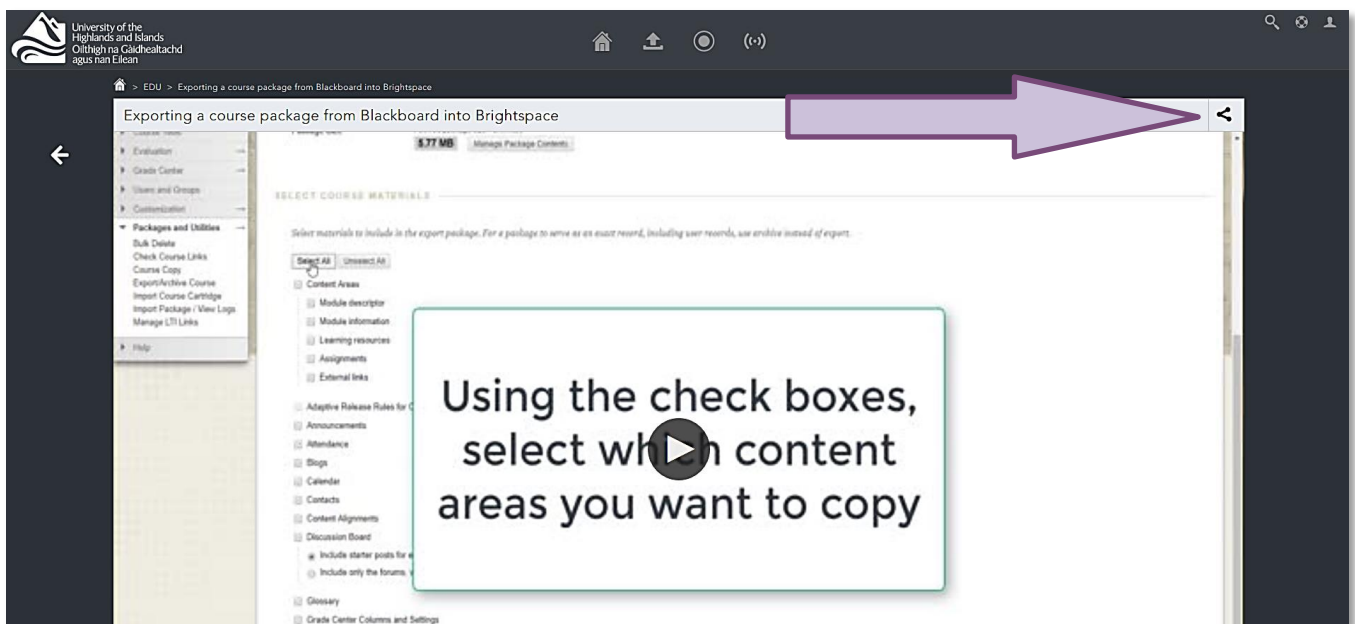

Figure 5: A video in the streaming server and the share symbol in the top right-hand corner

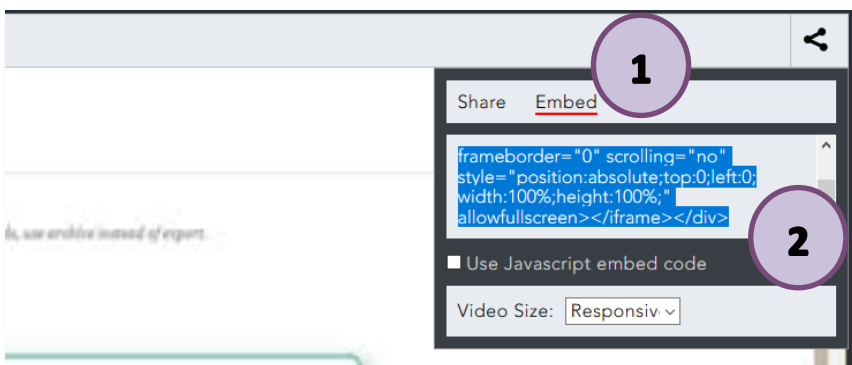

Figure 6: Share area in the streaming server and the video embed code

Once you have clicked on the share symbol, a menu will open. Select 'Embed' (1) and copy the embed code (2). (Figure 6)

Go back to Brightspace and paste the embed code into the text field (1). Click on 'Next' (2). (Figure 7)

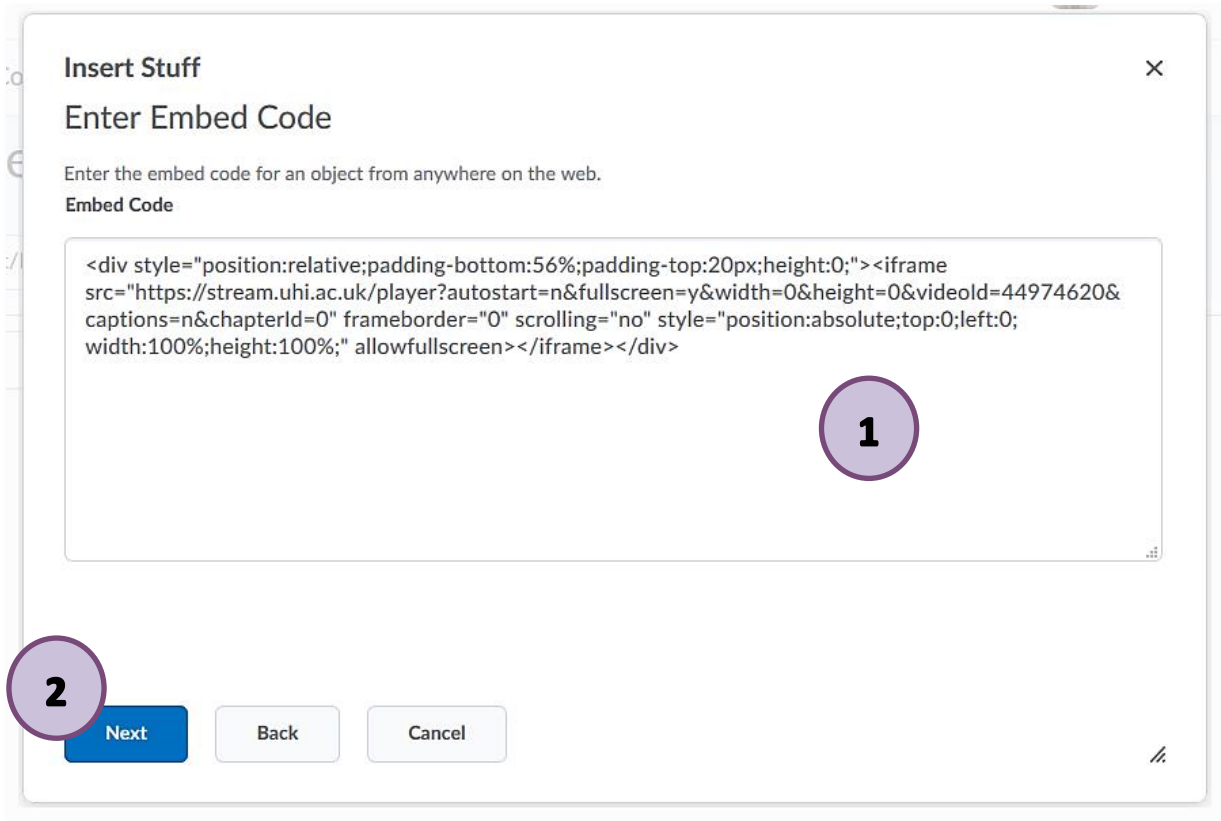

Figure 7: Brightspace Enter Embed Code window with pasted embed code from the streaming server

You will get a notification asking if you want for the video to be embedded since it comes from another website. Click 'Allow'. (Figure 8)

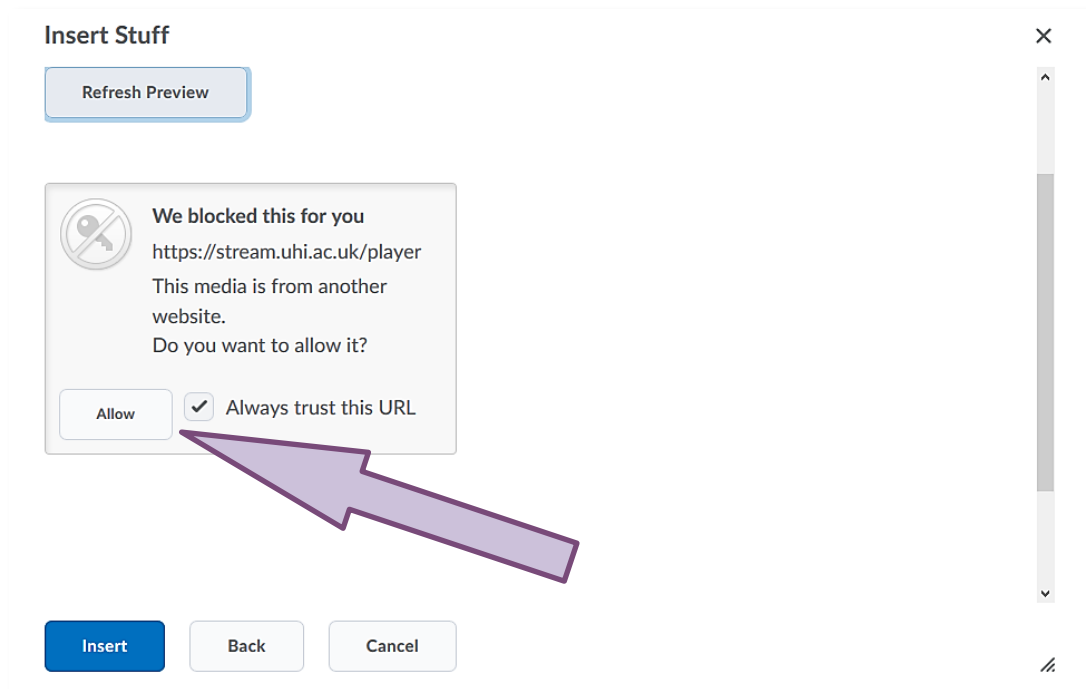

Figure 8: Allowing for a video from an external website to be embedded

You will now see a preview of the video you are embedding (1). Click on 'Insert' (2). (Figure 9)

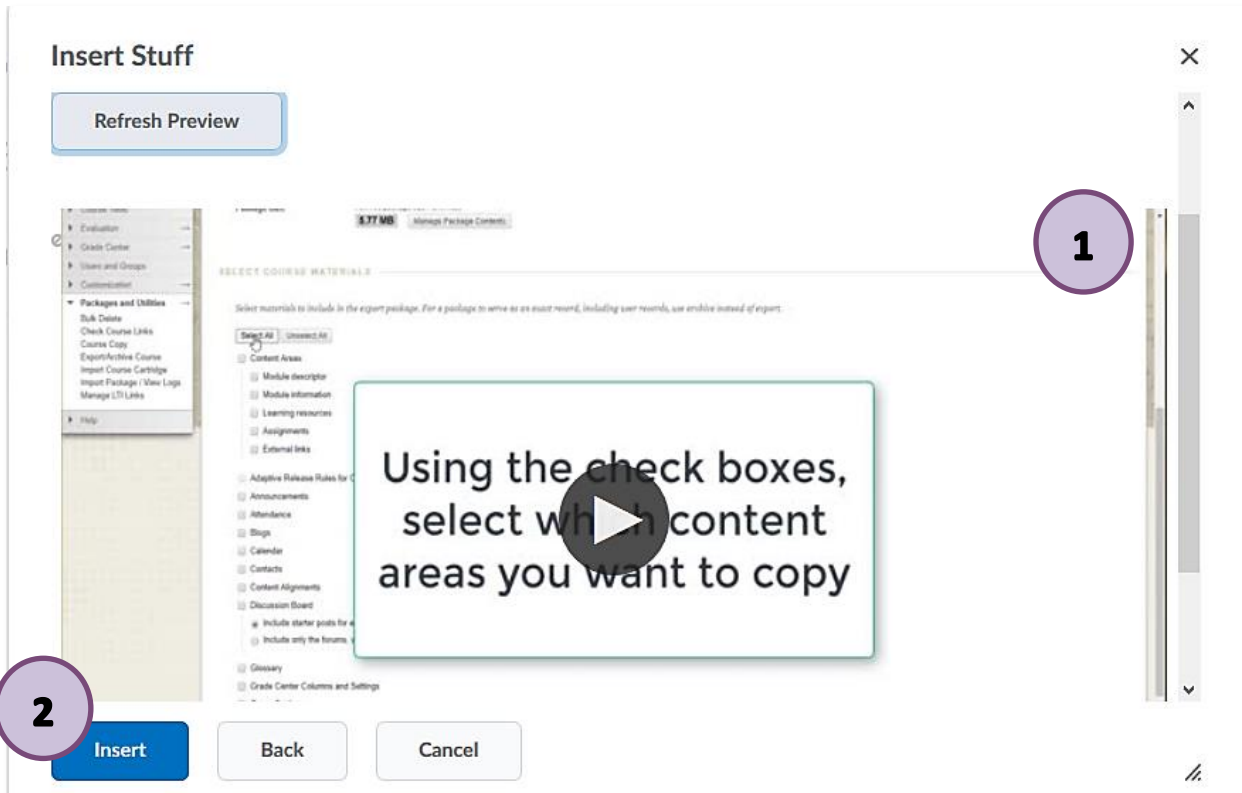

Figure 9: Preview of embedded video and blue Insert button

Once you have clicked on 'Insert', you will be taken back to the HTML editor. If you are happy with what the video looks like, click on 'Publish'. (Figure 10)

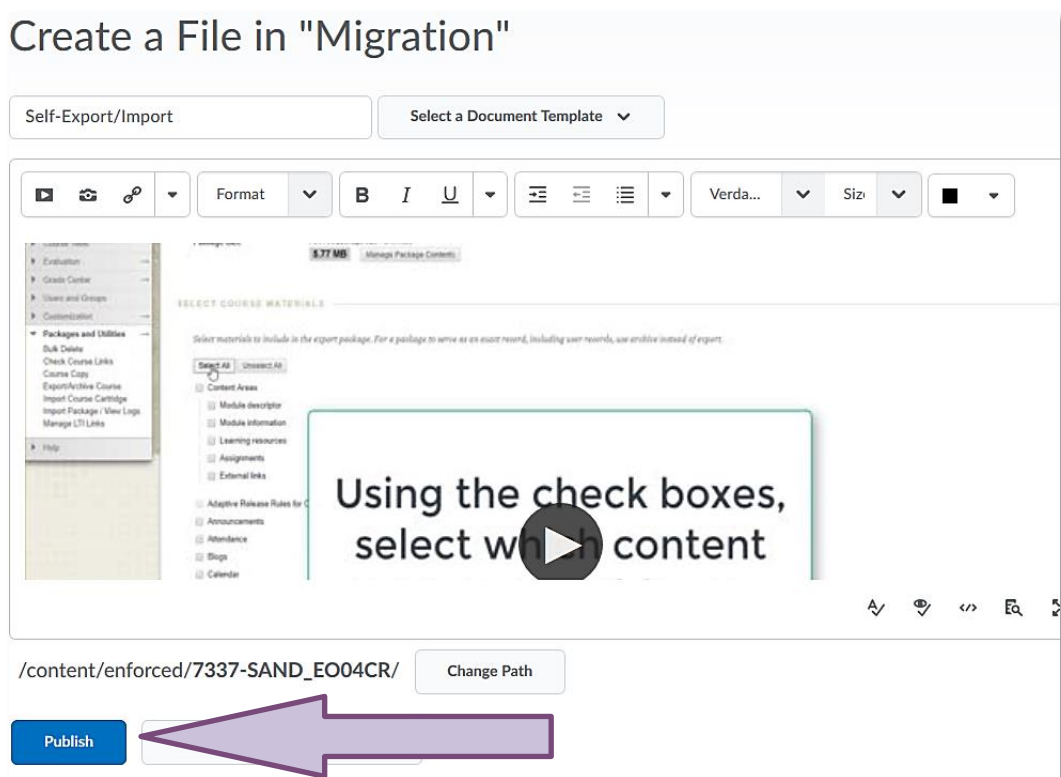

Figure 10: HTML editor with video in it and blue Publish button

Your video has now been successfully embedded.

Option 2 – Linking to a video from the UHI streaming server

Go to your module and the content folder where you would like to add a video. Select the 'Upload/Create' drop-down menu (1) and select 'Create a Link' (2). (Figure 11)

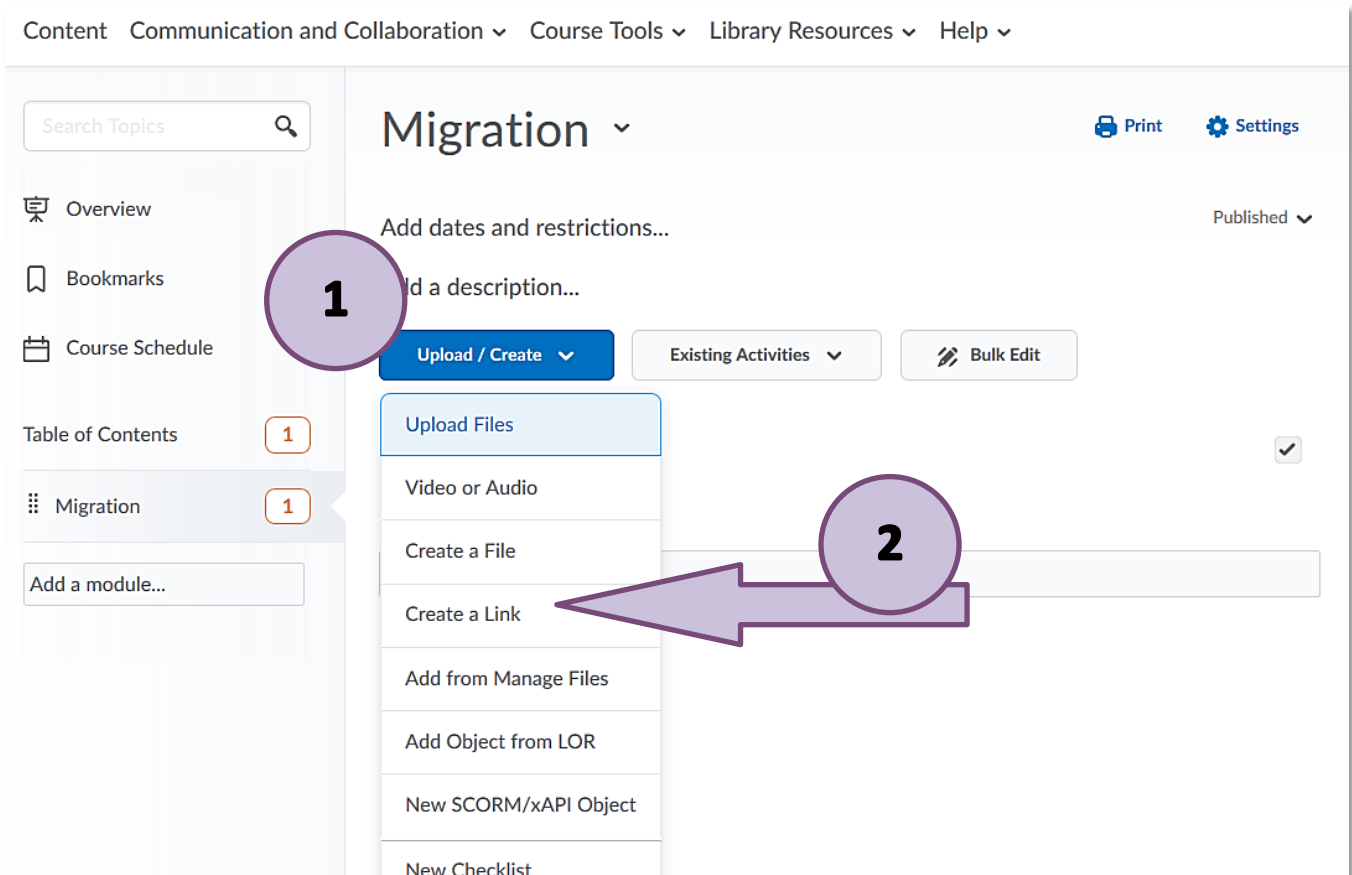
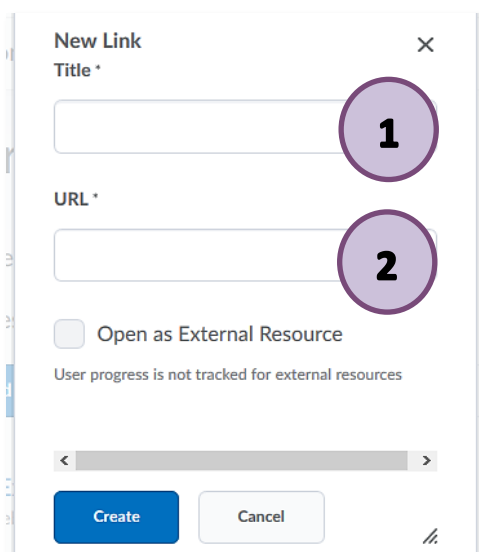

Figure 11: Brightspace content area with Upload/Create button and drop-down menu



Once you have clicked on 'Create a Link', a window will open, where you will be able to enter a title for your link (which will appear in the table of contents) (1) and the URL of your link (2). (Figure 12)

Figure 12: New link creation window

Go to the UHI streaming server and select the video you would like to link to. Once the video has opened, select the share symbol (🔗) at the top right-hand side corner. (Figure 13)

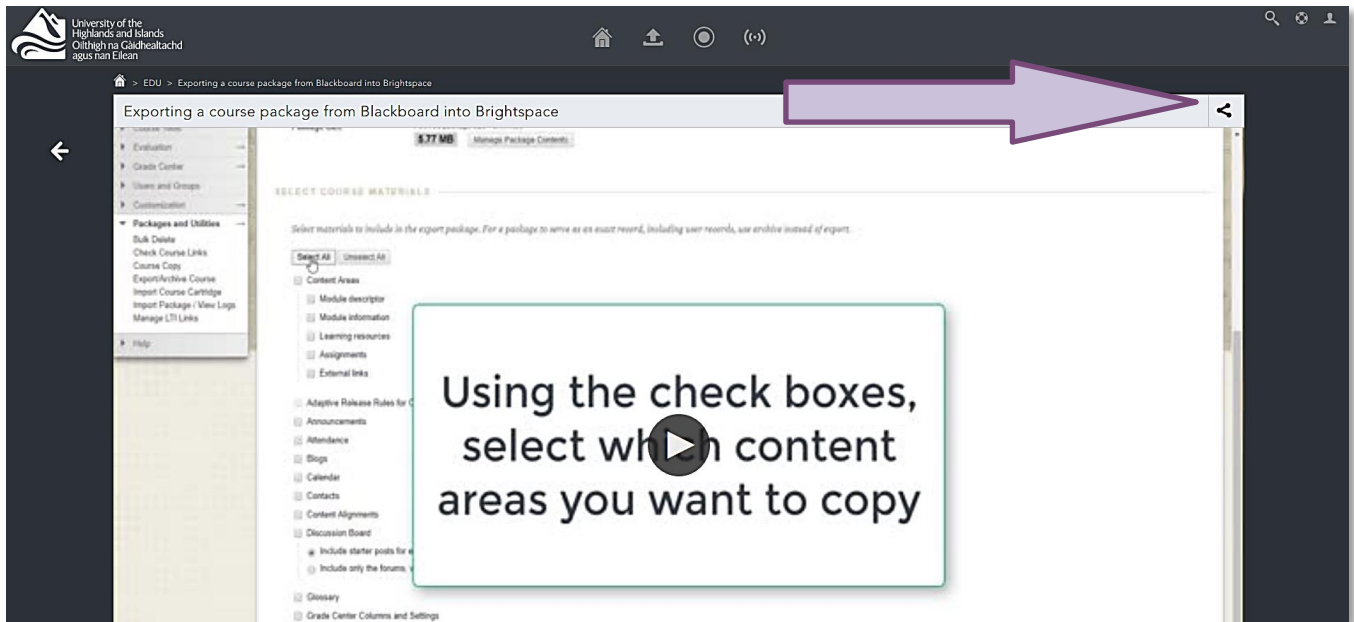

Figure 13: A video in the streaming server and the share symbol in the top right-hand corner

Once you have clicked on the share symbol, a menu will open. Select 'Share' (1) and copy the URL (2). (Figure 14)

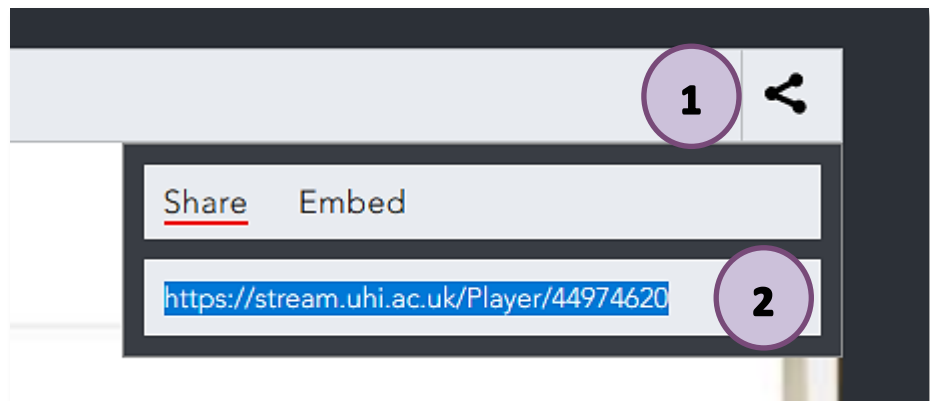
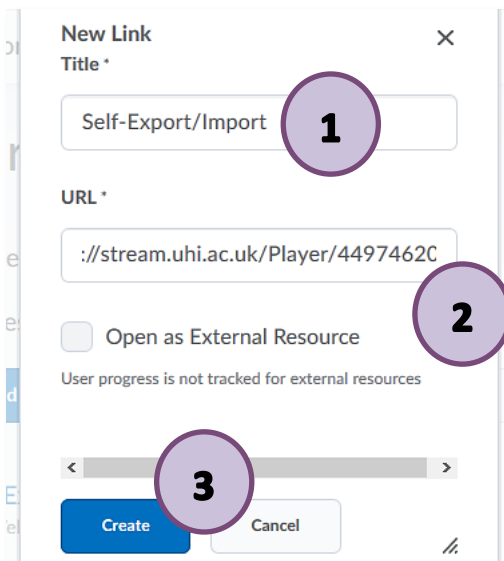

Figure 14: Share area in the streaming server and the video link



Go back to Brightspace. Give your link a title (1) and paste the URL into the URL field (2). Click on 'Create' (3). (Figure 15)

A link to your video has now been successfully created.

Figure 15: New link creation window with title, URL and blue Create button